

# AAMCS-PHD-470M-860M-250W-Nf

AA MCS

470-860 MHz

Hybrid Coupler 90°, 250W

## FEATURES

- UHF Unit
- Minimal RF Insertion Loss
- High Reliability, High Isolation
- N Female Connectors



PASSIVE COMPONENTS

## DESCRIPTION

The Directional and Hybrid couplers offered by AA MCS are designed for both commercial and military applications on range DC-50GHz. Models are available in connectorized SMA, BNC, N, TNC (option) packages, depending on the frequency. All units are designed and manufactured to ensure statistical control of important parameters such as insertion loss and input/output return loss, with power up to more than 1 kWatt.

## Electrical Specifications

<b>Bandwidth</b>		470-860 MHz
<b>Coupling</b>		3dB
<b>Insertion Loss</b>	Max	0.1 dB
<b>Isolation</b>	Min	23 dB
<b>Amplitude Balance</b>	Max	0.5 dB
<b>Phase Balance</b>	Max	2 Deg
<b>VSWR</b>	Max	1.17:1
<b>Power CW</b>	Min	250 W
<b>Connector</b>		N f
<b>Operating Temperature</b>	°C	-40 to +85°C
<b>Storage Temperature</b>	°C	-55 to +125°C
<b>Waterproof ness</b>		IP50

*Amplitude & Phase Balance are the ratio between any 2 output in dB or Deg respectively*

*Power indicated for load VSWR better than 1.20:1*

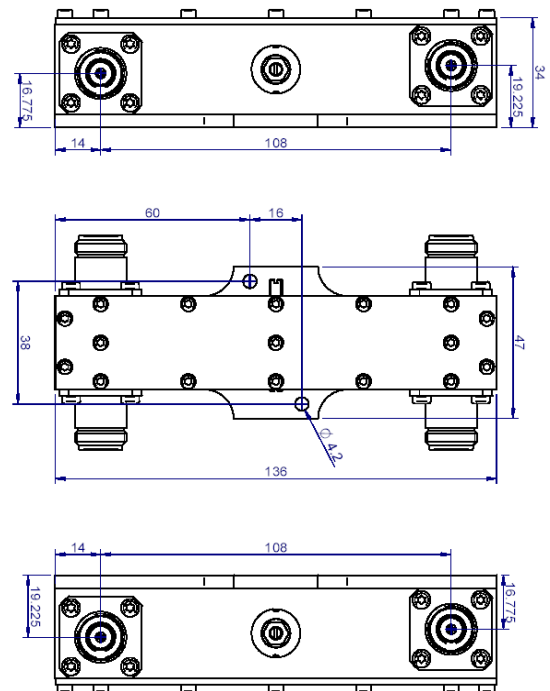

Outline is subject to change without prior notice

Size in mm



**AA MCS**  
MICROWAVE COMPONENTS AND SYSTEMS

AA Sa 18, rue Nicolas Appert F-91898 ORSAY - FRANCE

Tel : +33 (0)1 76 91 50 12 – Fax : +33 (0)1 76 91 50 31 – [www.aa-mcs.com](http://www.aa-mcs.com)

11/11