

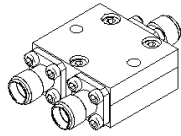

SPECIFICATIONS TECHNIQUES
TECHNICAL SPECIFICATIONS
AAMCS-PWD-2W-5G-18G-10W-Sf
2 ways power divider, 5-18G, 10W, SMA f

Page : 1 / 2

Caractéristiques électriques <i>electrical specifications</i>			
	Conditions de mesures <i>Measuring conditions</i>	Spécifications AA-MCS <i>AA-MCS specifications</i>	Unités Units
Bande de fréquence <i>Bandwidth</i>	-	5 - 18	GHz
Couplage nominal <i>Nominal coupling</i>	5 - 18 GHz	3	dB
Pertes d'insertion <i>Insertion loss</i>	5 - 18 GHz	≤ 0.6	dB
Variation de couplage <i>Amplitude balance</i>	5 - 18 GHz	≤ 0.2	dB
Variation de phase <i>Phase balance</i>	5 - 18 GHz	≤ 5	°
Impédance <i>Impédance</i>	5 - 18 GHz	50	Ohms
TOS <i>VSWR</i>	5 - 18 GHz	≤ 1.4 :1	-
Isolation <i>Isolation</i>	5 - 18 GHz	≥ 18	dB
Puissance moyenne * <i>Average Power *</i>	5 - 18 GHz	10	Watt
Caractéristiques mécaniques <i>Mechanical features</i>			
Longueur x largeur x Hauteur <i>Length x width x height</i>	L x W x H (Tol. ± 0.5)	20 x 23 x 10 (excluding connectors) Fixing Holes Diam= 2.8 mm	mm
Finition <i>Finish</i>	-	Black painting	
Connectique <i>Connectors</i>	-	SMA female	-
Poids <i>Weight</i>	-	17	grams
Conditions environnementales <i>Environmental conditions</i>			
Température de service <i>Operating temperature</i>	-	-45 à + 85	°C
Température de stockage <i>Storage temperature</i>	-	-55 à + 125	°C

* 10W for load VSWR better than 1.20:1

02/05/A



SPECIFICATIONS TECHNIQUES
TECHNICAL SPECIFICATIONS

AAMCS-PWD-2W-5G-18G-10W-Sf
2 ways power divider, 5-18G, 10W, SMA f

CARACTERISTIQUES MECANIKES (mm)
MECHANICALS FEATURES

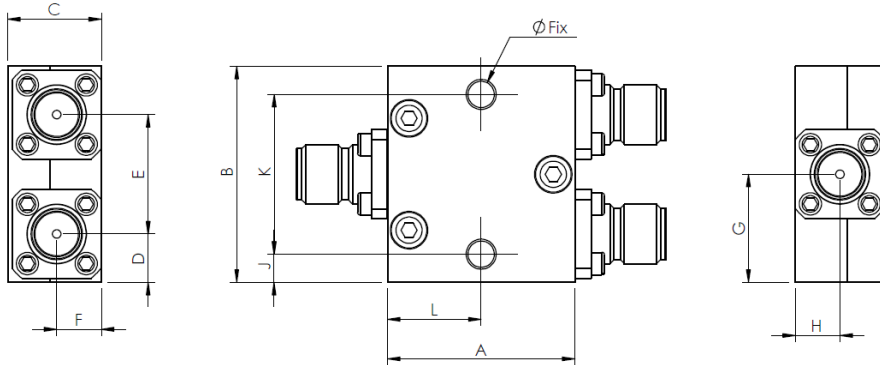

A	B	C	D	E	F	G	J	K	L	Fix
20	23	10	5.15	12.7	4.76	11.5	3	17	10	Ø 2.8

Dimensions in mm (Tol+/- 0.5mm)
 Drawing not to scale