

AAMCS-UDC-10G-40G-xxdB-2.9f

AA MCS

10-40 GHz

8-10dB Directional coupler

FEATURES

- Ultra broadband Unit
- Unidirectional Coupler
- Minimal RF Insertion Loss
- High Reliability
- 2.9mm Female Connectors



PASSIVE COMPONENTS

DESCRIPTION

The Directional and Hybrid couplers offered by AA MCS are designed for both commercial and military applications. Models are available in connectorized SMA, BNC, Type N, TNC (option) packages, depending on the frequency. All units are designed and manufactured to ensure statistical control of important parameters such as insertion loss and input/output return loss, with power up to more than 1 kWatt.

Electrical Specifications

Bandwidth	10-40 GHz		
Nominal coupling			
AAMCS-UDC-10G-40G-8dB-2.9f	Max	8 ± 1.1 dB	
AAMCS-UDC-10G-40G-10dB-2.9f		10 ± 0.7 dB	
Coupling Flatness	Max	± 0.40 dB	
Main Line Insertion Loss *	Max	1.70 dB	
VSWR	Max	1.70:1	
Directivity			
AAMCS-UDC-10G-40G-8dB-2.9f	Min	10-20G	12dB
		20-40G	10dB
AAMCS-UDC-10G-40G-10dB-2.9f		10dB	
Power CW	Min	30 W	
Connector	2.9mm f		
Operating Temperature	°C	-40 to +85°C	
Storage Temperature	°C	-55 to +125°C	
Waterproof ness	IP50		

* including coupling loss

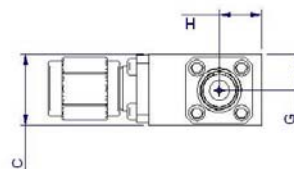
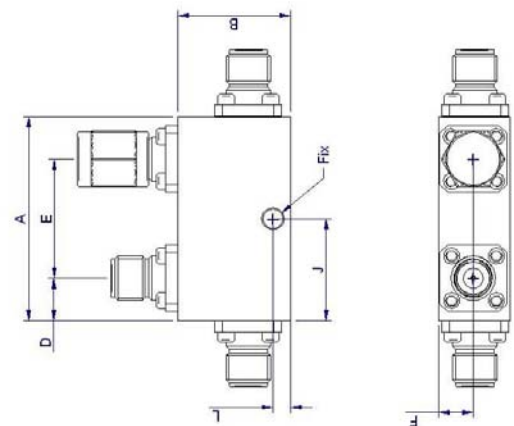

Outline is subject to change without prior notice

A	B	C	D	E	F
29	16	10.1	6	17	5
G	H	J	L	Fix	
5.2	6	14.5	2.5	M2.8	

Size in mm



AA MCS

MICROWAVE COMPONENTS AND SYSTEMS

AA Sa 18, rue Nicolas Appert F-91898 ORSAY - FRANCE

Tel : +33 (0)1 76 91 50 12 – Fax : +33 (0)1 76 91 50 31 – www.aa-mcs.com

07/11